

## Installation Guidelines

Always check the installation surface to ensure that the substrate will be strong enough to hold the weight of your MedalMinder and medals.

All installation must be done so with proper hardware and protective gear to insure safety. It is important to check that parts are properly tightened at the end of installation.

- 1** Use the holes in your MedalMinder as a template to mark holes on your mounting surface.

- 2** Pre-drill 3/16" holes in your surface, then insert nylon anchors into the holes and tap them flush.

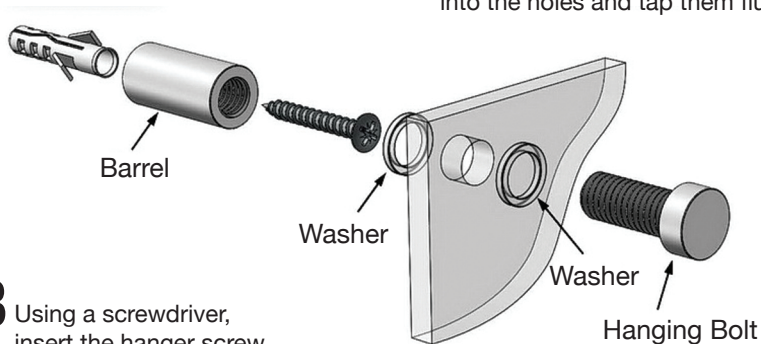

- 3** Using a screwdriver, insert the hanger screw through the barrel and into the nylon anchors, then tighten to surface.

- 4** Place rubber washer on bolt and insert through MedalMinder pre drilled holes and thread into barrel until tight.